

避障器 使用说明书

安装说明

1. 取出盖片：用小卡片插入飞机面盖避障器底座，取出盖片；图1
2. 安装避障器：用力捏住避障器两边切口位，将其插入避障器底座；图2
3. 取出避障器：取出时，用力捏住避障器两边切口位，拔出避障器；图3
4. 必须在关机的情况下安装或取出避障器，否则可能会损坏避障器；

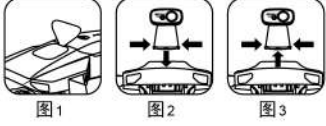

安装注意事项：

- 1) 应小心安装避障器和盖片，避免损坏卡扣；
- 2) 取出避障器时，切勿拉避障器上部分，否则会损坏避障器；

使用说明

1. 本避障器使用激光扫描避障，可实现前后左右四个方向360°扫描避障，操作遥控器右摇杆，避障器随飞机同步指向，当检测到障碍物时，遥控器发出持续哔哔声；
2. 室内检测距离约5米左右；
3. 室外检测距离约20米，5-10米左右飞机会停止；

使用注意事项：

- 1) 在使用前，需撕掉避障器镜头保护膜，否则会影响避障效果；
- 2) 使用过程中，禁止触碰避障器；
- 3) 眼睛不得直视避障器镜头；
- 4) 在强光、光线黑暗、前方玻璃等特殊环境下避障器功能会失效；
- 5) 无人机低电时，低电报警优先。

请扫二维码观看避障视频！



OBSTACLE AVOIDANCE SENSOR (SENSOR) INSTRUCTION

Sensor installation instructions

1. Insert the card into the base of the sensor, and take out the cover sheet. (Pic.1)
2. Install the sensor: Firmly pinch the incisions on both sides of the sensor, and insert it into the base. (Pic.2)
3. Take out the sensor: Firmly pinch the incisions, and pull out the sensor. (Pic.3)
4. The sensor must be installed or removed when the drone is turned off, otherwise the sensor may be damaged.

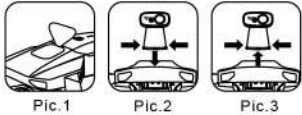

Note:

- 1) Install the sensor and sheet carefully to avoid damage to the buckle.
- 2) When taking out the sensor, do not pull the upper part of the sensor, otherwise it will be damaged.

Sensor instructions

1. This obstacle avoidance device uses laser scanning to avoid obstacles, which can realize 360° scanning obstacle avoidance in four directions (front, back, left, and right). Operate the right joystick of the remote control, the sensor will point synchronously with the drone. When an obstacle is detected, the remote control will send out constant BIBI.
2. The indoor detection distance is about 5 m.
3. The outdoor detection distance is about

20 m., and the drone will stop at about 5-10 m.

Note:

- 1) Need to tear off the film of the sensor lens.
- 2) During use, it is forbidden to touch the obstacle avoidance device.
- 3) Do not look directly into the lens of the sensor.
- 4) The obstacle avoidance function fails in environments such as strong light, dark light, front glass, etc..
- 5) When the drone is low power, the low power alarm has priority.

Scan the QR code
to watch the
sensor video!

