

KNOW YOUR BELLWETHER

With 2.4G frequency band for long remote control distance, BELLWETHER allows multiple flights at the same time without any interference. User can control it by, hover and take photos/videos with APP and WIFI connection on smart phone.



- ① Upper Coasting
- ② Lower Coasting
- ③ Propeller
- ④ Motor
- ⑤ Camera
- ⑥ Thrust
- ⑦ Protective Guard
- ⑧ Circuit board
- ⑨ Gimbal
- ⑩ Battery

1

ACCESSORIES



NOTES:
Please check the number of accessories carefully as shown above. Please provide proof of purchase and contact the store for replacement if any missing parts.

2

PRE-FLIGHT PREPARATION

1 Flight Environment

- Indoor: Spacious spaces away from barriers, crowds or pets are preferred.
- Outdoor: Sunny, windless and breezy weather are preferred.

Please keep the drone in sight during the flight and keep it away from barriers, high-tension cables, trees and people.

Do not fly in extreme environment, such as hot/dry, cold/dry, strong wind or heavy rain.

3

2 Propellers Replacement

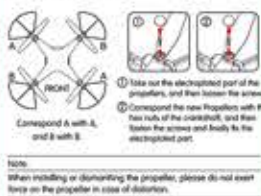

NOTES:
When installing or dismantling the propeller, please do not exert force on the propeller in case of distortion.

4

3 Battery Charging for Drone



NOTES:
LED lights off when charging and red light turn on when full charging completes. Charging time is about 100 minutes.

Battery Instructions

There is a certain risk when using lithium battery. It may cause fire, body injury or property loss. Users must be aware of the risks and take full responsibility of using battery properly.

If battery leakage occurs, please avoid contacting your eyes or skin with electrolyte. Once it happens, please wash your eyes with clean water and seek medical care immediately.

Please remove the plug immediately if you sense any peculiar smell, noise or smog.

Battery Charging

- Please use the charger from original factory to ensure your safe usage.
- Do not charge distant or outdoor battery.
- Do not over-charge battery. Please unplug the charger once fully charged.
- Do not charge the battery near to inflammables, such as carpet, timber floor or wood furniture or on the surface of electro-conductive objects.
- Please always keep an eye on the battery when charging.
- Do not charge battery which not cool down yet.
- The charging temperature should be between 0°C to 40°C.

Battery Recycling

- Do not dispose the battery as daily rubbish. Please familiarize yourself with the local garbage disposal method and dispose it according to the special requirement.

5

KNOW YOUR REMOTE CONTROL

1 Operation Board of the Remote Control

- ① One-Key Start/Landing
- ② One-Key Reset
- ③ Speed Control
- ④ Plus & Minus Long Press to Headless Mode
- ⑤ Power Light
- ⑥ Left Joystick
- ⑦ Right Joystick
- ⑧ Power
- ⑨ Left / Right Rotation Fine-tuning
- ⑩ Forward / Backward Fine-tuning
- ⑪ Left / Right Sideward Fine-tuning

6

2 Battery Assembling for Remote Control

Open the cover of battery compartment, insert 4 AA batteries and ensure the polarity symbols on the battery match the symbols inside the battery compartment.

NOTES:

- Ensure the polarity symbols on the batteries match the symbols inside the battery compartment.
- Do not mix new and old batteries.
- Do not mix different types of batteries.

7

3 Pairing Remote Control with Drone

- Turn on the power of the drone, put the drone on plain ground, check whether the indicator lights of remote control and LED lights of drone flash.
- Press "One-Key Start" to activate the motor and propellers, the drone will take off and then fly at a height of 1.5 m above the ground.

8

FLY WITH REMOTE CONTROL

1 Flying

The left joystick is used to control flying height and left and right turning, while the right joystick is used to control forward, backward and sideward flights.

Left joystick

Right joystick

9

Flips and Rolls

Hold the drone to fly over 2 meters, press the button of flips and rolls and move the right joystick to certain direction to finish flips and rolls.

Right Joystick

Hovering

Operate the left joystick to make the drone ascend and then release the joystick. The drone will hover at the height you release the joystick.

Left Joystick

10

2 Fine-tuning

Gradually push the accelerator joystick to make the drone ascend, fine-tune the direction when the drone stops or deviates to one direction.

NOTES:
"Ground effect" means when the drone flies very close to the ground, the effect of ground can result in "floating" when landing or temporarily "not spaced" when the drone flies at a ground level approximately below 30 cm from the ground, the action will influence the steadiness of the flight, raising ground effect.

11

KNOW YOUR REMOTE CONTROL APP

1 WIFI Connection

- Use your phone to scan the QR code, download and install the control software: JIRC, Android, Android/Google Play and IOS are all supported.

2 Turn on the drone and the lights will flash/turn on your mobile phone to connect JIRC (JAW-88888), as shown in figure.

12

2 APP Interface Instruction

14

FLY WITH APP

1 Pairing Remote Control With Drone

Click "1: ON", then click "2: Altitude Hold" to pair remote control with the drone.

2 One-Key Start

Click "One-Key Start" to activate the motor and propellers, the drone will take off and then fly at a height of 1.5 m above the ground.

15

3 Basic Flight

Use the left joystick to control the flight altitude and turn left/right, and the right joystick to control the forward, backward, left and right sideward flight directions.

Left joystick

Right joystick

16

Flips/Rolls

When the drone is reaching more than 3 meters high, click "Flips/Rolls" and move the right joystick to a certain direction, the drone will rotate in that direction.

18

Hover

When you release the left joystick (throttle) after the ascend/descend action, the drone will hover at a certain height.

19

4 Take Selfies

If the drone rotates or yaws, click the "Fine-tuning" button on the camera towards yourself, then click the camera turn on the screen to take selfies.

5 Gravity Sensor Control

Click to enter Gravity Sensor Control, put your right hand thumb on the right joystick, and move the phone towards any direction to start operation.

20

6 Fine-tuning

If the drone rotates or yaws, click the "Fine-tuning" button on the reverse direction of yawing till the yaw is adjusted and the drone stops entirely of the control.

21

7 One-key reset

When deviating from course due to crash, please control the drone back to a horizontal plane and click "One-key Reset" to re-calibrate the gyro and take off again.

NOTES:
When the drone is within 30m from the ground, it will be affected by the breeze and become unstable. This is "ground effect" the lighter the drone is, the greater the effect will be.

22

8 Flight Planning

When the drone takes off, click "Flight Planning" button to activate flight path mode. Draw a path in the blank, and the drone would perform the flight path of the altitude as you plot and fly on its own.

9 Beauty Mode

The built-in beauty mode on camera can automatically beautify images to deliver improved and skimming images with outstanding qualities.

23

FAQ

PROBLEMS	CAUSES	SOLUTIONS
Control failure	Not connect with the drone battery	Connect the drone battery in right way
	Too strong wind force	Do not fly in windy area. The performance and the control of the drone will be affected by the strong winds.
Fail to ascend	Propellers in slow motion	Push up the throttle joystick
	The battery of the drone is not fully charged	Fully charge the drone.
Landing too soon	The throttle joystick is pulled down too fast	Put down the throttle joystick slowly to perform a smooth landing.
Out of control	Beyond the effective controlling distance	Ensure that the flying distance is within 30 meters.

24

JIRC TECHNICAL SUPPORT

Dear Customer,

Thank you for choosing JIRC product. Please visit JIRC official website for more FAQ and information if there is any problem of using our product.

- Product Operation: Please visit JIRC College for tutorial video or user manual.
- Product Features: Please refer to product page description or product brochure.
- After-sale Service: Please refer to conditions and terms of after-sale service.

The final interpretation right belongs to all JIRC.

Should you have any further questions, please visit JIRC Online Feedback and leave your message.

Thank you again for your support!

JIANLIAN TECHNOLOGY CO.,LTD.
www.jirc.com

25