



CADY WILLY

HUMAN FOLLOWING ROBOT WITH SMARTWATCH CONTROL

*Please read the user manual carefully before operation and keep the manual in proper place for future reference.

KNOW YOUR CADY WILLY

CADY WILLY is an intelligent auto-follow robot with smart watch remote control. It can mimic human to walk, slide, turn around and dance. It can also play music, display programmed movements and automatically follow human via smart watch control. There are three control modes to operate the robot, i.e. smart watch control, gesture control and remote control, providing an enhanced experience for players.

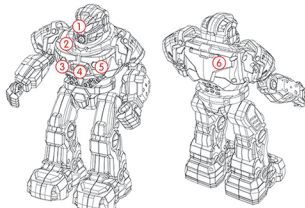

- ① Power Indicator Light/Charging Indicator Light
- ② IR Receiver/Auto Follow Sensor
- ③ Wake Up
- ④ Gesture Control Sensor
- ⑤ Power
- ⑥ Socket

1

ACCESSORIES

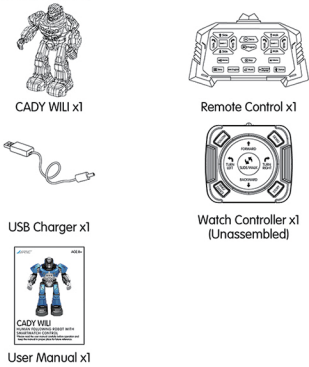

Notes:
Please check the number of accessories carefully (as shown above). Please provide proof of purchase and contact the store for replacement if any missing parts.

2

SMART WATCH ASSEMBLY

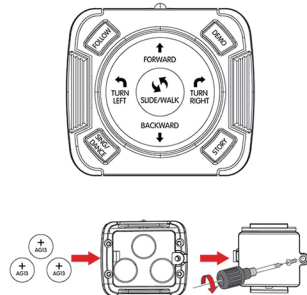

- Counter-clockwise loose the screws on the battery compartment cover of the smart watch.
- Insert three AG13 button batteries (included) with the positive and negative poles aligned correctly.
- Refit the cover and clockwise tighten the screws until fixed.

3

BATTERY ASSEMBLY AND CHARGING FOR ROBOT

1. Battery Assembling for Remote Control



Open the cover of battery compartment, insert two AA batteries (not included).

Notes:

- Ensure the polarity symbols on the batteries match the symbols inside the battery compartment.
- Do not mix new and old batteries.
- Do not mix different types of batteries.

2. Robot Body Charging

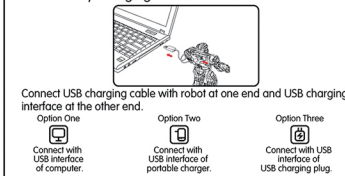

Connect USB charging cable with robot at one end and USB charging interface at the other end.

- Option One: Connect with USB interface of computer.
- Option Two: Connect with USB interface of portable charger.
- Option Three: Connect with USB interface of USB charging plug.

Notes:

It takes about 1.5 hours to charge up to full, and the run time of robot is about 3 hours after it is fully charged.

4

Battery Instructions

- There is a certain risk when using lithium battery. It may cause fire, body injury or property loss. Users must be aware of the risks and take full responsibility of using battery improperly.
- If battery leakage occurs, please avoid contacting your eyes or skin with electrolyte. Once it happens, please wash your eyes with clean water and seek medical care immediately.
- Please remove the plug immediately if you sense any peculiar smell, noise or smog.

Battery Charging

- Please use the charger from original factory to ensure your safe usage.
- Do not charge dilant or outworn battery.
- Do not over charge battery. Please unplug the charger once fully charged.
- Do not charge the battery next to inflammables, such as carpet, timber floor or wood furniture or on the surface of electro-conductive objects. Please always keep an eye on the battery when charging.
- Do not charge battery which not cool down yet.
- The charging temperature should be between 0°C to 40°C.

Battery Recycling

- Do not dispose the battery as daily rubbish. Please familiarize yourself with the local garbage disposal method and dispose it according to the special requirement.

5

KNOW YOUR SMART WATCH

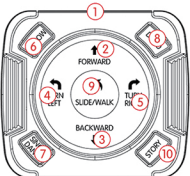

- ① Infrared
- ② Forward
- ③ Backward
- ④ Turn Left
- ⑤ Turn Right
- ⑥ Follow
- ⑦ Sing/Dance
- ⑧ Demo
- ⑨ Slide/Walk
- ⑩ Story

6

CONTROL WITH SMART WATCH

1. Follow

Press the "Follow" button, and you'll hear an audio message and the robot would automatically follow human who is wearing the smart watch. Press again to turn off auto follow mode (Aim the infrared at the robot's head when the robot is following to ensure a smooth control).

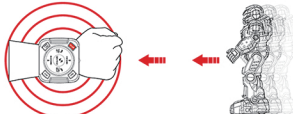

2. Forward/Backward

Press the "Forward/Backward" button, and you'll hear an audio message and the robot would move forward or backward. Long press the "Forward/Backward" button, and the robot would keep moving forward or backward with sound effects.

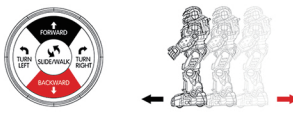

7

3. Turn Left/Turn Right

Press the "Turn Left/Turn Right" button, and you'll hear an audio message and the robot would left or right. Long press the "Turn Left/Turn Right" button, and the robot would turning left or right with sound effects.

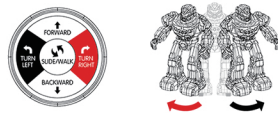

4. Slide/Walk

Sliding mode is the default mode. Press the "Slide/Walk" button, and you'll hear a clear sound of foot, after which the robot would switch to walking mode. Press again to switch to sliding mode.

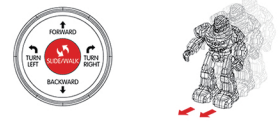

8

KNOW YOUR REMOTE CONTROL

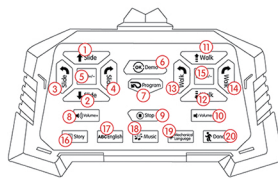

- ① Slide Forward
- ② Slide Backward
- ③ Slide Turn Left
- ④ Slide Turn Right
- ⑤ Speed
- ⑥ Demo
- ⑦ Program
- ⑧ Volume +
- ⑨ Stop
- ⑩ Volume -
- ⑪ Walk Forward
- ⑫ Walk Backward
- ⑬ Walk Turn Left
- ⑭ Walk Turn Right
- ⑮ Speed
- ⑯ Story
- ⑰ ABC English
- ⑱ Music
- ⑲ Mechanical Language
- ⑳ Dance

9

ABOUT THE REMOTE CONTROL

1. Start Up

Power on the robot. The robot would start up with an audio message: "Hello, I am CADY WILLY, Gypsy Danger. My planet was destroyed five thousand years ago, and now you are my only existing. I am willing to leave no means to protect you and accompany you. Now give orders to me. If you ask me what I can do, I can sing songs, as well as dance. Now give orders to me."

2. Standby

In the start-up mode, the robot would enter standby mode after 20 seconds of inactivity and then enter sleep mode after 180 seconds of inactivity. It would remind you through six audio messages before entering standby mode and through one audio message before entering sleep mode. If you want to wake up the robot when it is in sleep mode, just press the "Wake Up" button to restart.

3. Shut Down

Press the power button again to shut down the robot.

4. Slide Forward/Backward



10

5. Slide Turn Left/Turn Right

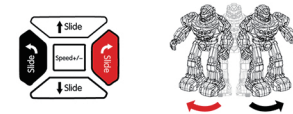

6. Walk Forward/Backward

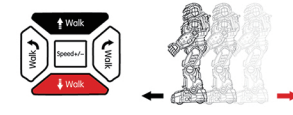

7. Walk Turn Left/Turn Right



11

8. Gesture Control

Power on the robot, put your hand on the gesture control sensor and control functions such as forward, backward, turn left and turn right.

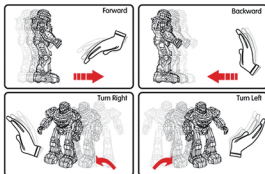

9. Sliding Speed

Press the "Speed" (Slide) button to control the robot to quicken its sliding movements in four directions (i.e. forward, backward, turn left and turn right). Press again to switch to the normal speed.

10. Walking Speed

Press the "Speed" (Walk) button to control the robot to quicken its walking movement in four directions (i.e. forward, backward, turn left and turn right). Press again to switch to the normal speed.

11. Display

Short press the "Display" button to control the robot to play a dancing song or a line of audio prompts.

- ① "I am not in the good mood, I don't want to sing."

12

② "Dancing has been always my strength."

③ "The dances that I know are beyond count."

④ "I hear that this song is very hot on your earth."

⑤ "Oops! It is urgent now, I have to stop singing."

12. Program

Press the "Program" button, and the robot would respond with "Well now, please edit the orders that you would like to give" and enter programming mode. In this mode, you can use the function buttons to create up to 50 combinations of movements. After finishing the programming, press the button again. On hearing a clear sound of beep, the robot would start to replay the programmed movements.

13. Volume +/-

There are six levels of volume, with the default level at the forth level. Press the "Volume +/-" button to volume up or down. When the volume peaks the highest or drops to the lowest, the robot would respond with "Maximum volume" or "Minimum volume".

14. Stop

Press the "Stop" button, and the robot would stop.

15. Story

Press the "Story" button, and the robot would start to tell stories. There are four stories. By the end of the story, press once to listen to the next story.

- ① My planet was invaded, we fought hard. Unfortunately, we failed, the enemy destroyed my planet. Only I drifted to the earth. I've lost my homeland, and you are my only remaining little friend. Let me accompany you all the time.

13

② I was a bodyguard droid before, who had been guarding our headquarters. My headquarters is so far away from the earth, which is on the other side of the galaxy. At that time, we watched the earth, wondering why there should be such a so beautiful place. The earth is in the solar system, as far as we know, it is the only planet that host life in the solar system.

③ Our planet is not as full of life as the earth does, 71% of the earth is covered with ocean, and only 29% is land. Ours is quite different, there are green grassland, high mountains and cities mankind live in. While in our planet, only inanimate iron cities exist without a trace of life.

④ Although the earth is such a beautiful planet, you mankind always do not cherish the beautiful everything in front of you, leave the beautiful planet polluted. Throw garbage here and there, cut down trees recklessly, and emit carbon dioxide, all of which are very dangerous.

16. ABC English

Press the "ABC English" button, and the robot would start to teach you English. There are three units. By the end of the unit, press once to go to the next unit.

- ① On the earth, English is a quite important course indeed. It can help you to communicate with your friends from all over the world. If you don't understand, I can teach you some. (English teaching materials)
- ② I've learned a lot of stuff during my several years on the earth, including English, are you interested in it? I have a lot of things to teach you. (English teaching materials)

14

③ Come ,come, come, I am just starting to learn English, let me teach you.

17. Music

Press the "Music" button, and the robot would start to play music. There are three clips. By the end of the song, press once to play the next clip.

- ① I like my present life, let me sing a joyful song for you. (Joyful music)
- ② I think of my homeland, let me sing a sad song for you. (Mourful music)
- ③ I feel full of strength, let me sing an exciting song for you. (Encouraging music)

18. Mechanical Language

Press the "Mechanical Language" button, and the robot would start to speak mechanical language. There are four units. By the end of the sentence, press once to enter the next unit.

- ① Are you sure to listen? I think you cannot understand. Our language is like this.
- ② This sentence means "how are you" in our place.
- ③ I couldn't help missing my homeland.
- ④ Oh no, dangerous.

19. Dance

Press the "Dance" button, and the robot would start to play music. There are five pieces of songs. By the end of the song, press once to play the next song.

15

JJRC TECHNICAL SUPPORT

Dear Customer,

Thank you for choosing JJRC product. Please visit JJRC official website for more FAQ and information if there is any problem of using our product.

-Product Operation: Please visit JJRC College for tutorial video or user manual.

-Product Features: Please refer to product page description or product brochure.

-After-sale Service: Please refer to conditions and terms of after-sale service.

The final interpretation right belongs to all JJRC.

Should you have any further questions, please visit JJRC Online Feedback and leave your message.

Thank you again for your support!

JIANJIAN TECHNOLOGY CO, LTD.
www.jjrc.com

16